

# ODYSSEY SE

2025 GAS CLASS C MOTORHOME



2025 ENTEGRA COACH ODYSSEY SE





# 2025 ODYSSEY SE

## Gas Class C Motorhome

22A | 22AF

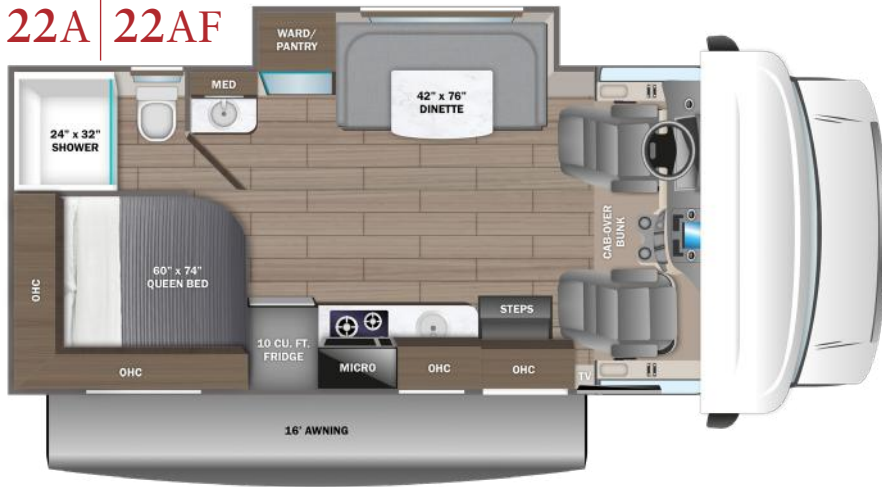

22C | 22CF

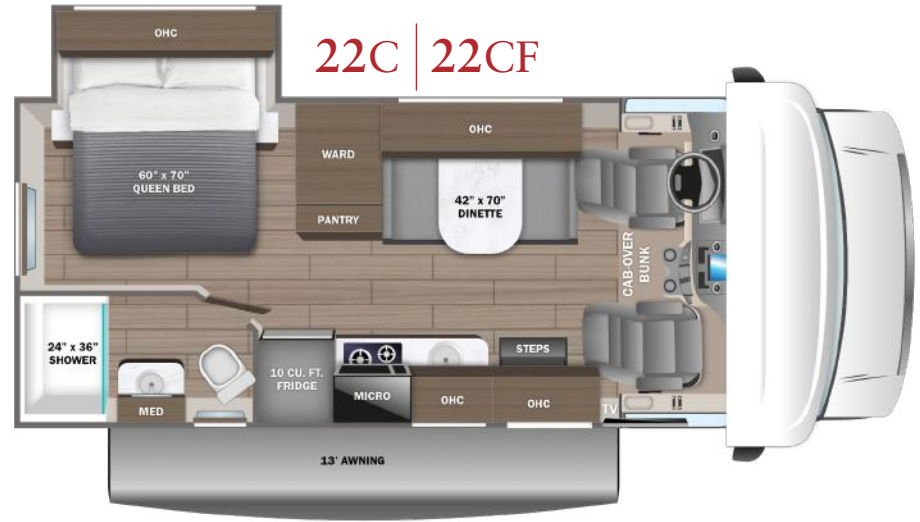

22E | 22EF

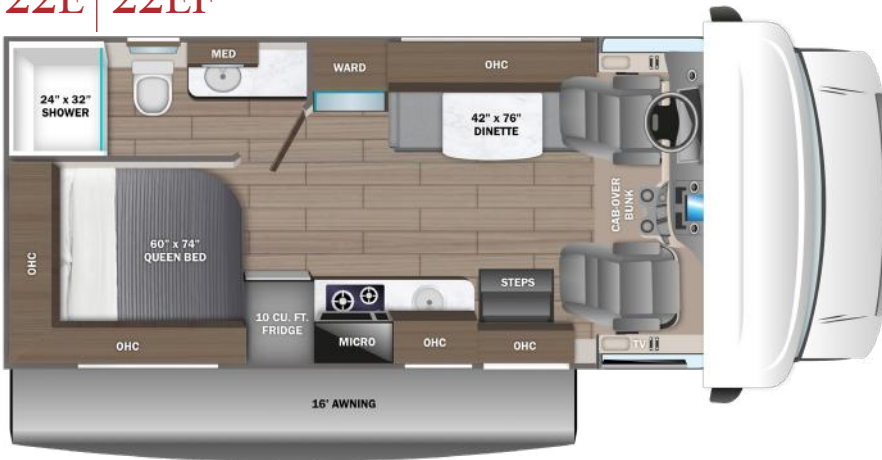

22T | 22TF

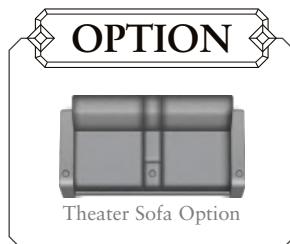
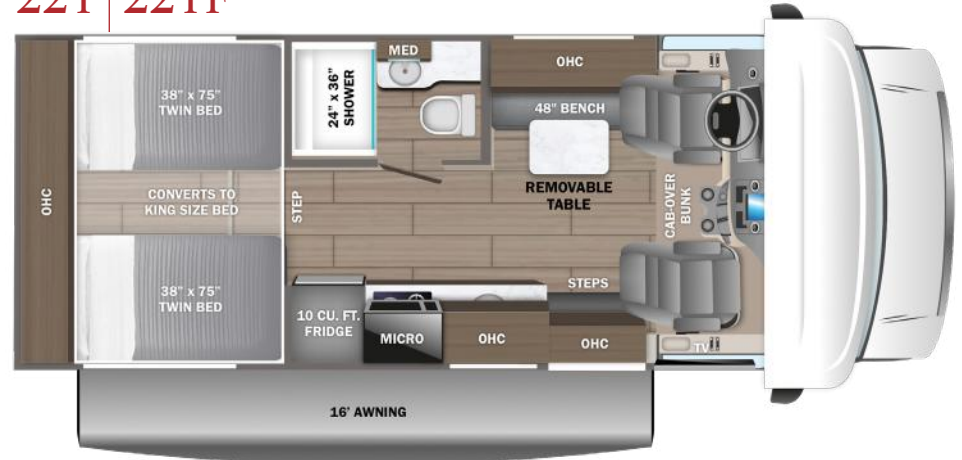

### EXTERIOR SELECTION



## CUSTOMER VALUE PACKAGE

One-piece, seamless, fiberglass front cap  
 Heated holding tanks (12V pads)  
 Electric patio awning  
 Black holding tank sprayer  
 Backup camera  
 LED HD Smart TV

## STANDARD CHASSIS EQUIPMENT

**Chassis Equipment for 22A, 22C, 22E, 22T**  
 Chevy® 4500 chassis  
 GVWR- 14,200 lb.  
 GCWR- 20,000 lb.  
 6.6L Vortec V8 401 HP engine with 464 ft.-lb. torque  
 Hydra-matic 6-speed automatic transmission with overdrive  
 150-amp alternator  
 57 gal. fuel tank  
 StabiliTrak stability control system  
 OnStar with 4G LTE

## Chassis Equipment for 22AF, 22CF, 22EF, 22TF

Ford® E-350 chassis  
 GVWR- 12,500 lb.  
 GCWR- 18,500 lb.  
 7.3L V-8 325 HP engine with 450 ft.-lb. torque  
 6-speed TorqShift® series transmission with overdrive  
 210-amp alternator  
 55 gal. fuel tank  
 Tire pressure monitoring system (TPMS)  
 Catalytic converter theft deterrent  
 Electronic stability control  
 Traction control

## Chassis Equipment on All Floorplans

5,000 lb. hitch with 500 lb. tongue capacity and 7-pin plug  
 E-rated highway tires- LT225/75R16  
 12V chassis battery  
 Power anti-lock brakes with power steering  
 Remote-controlled, side-view mirrors

## STANDARD EXTERIOR EQUIPMENT

TuffShell™ vacuum-bond laminated roof, floor and sidewalls  
 Bead-foam insulation (R-24 max roof, R-9 max floor, R-5 max walls)  
 Tufflex™ PVC laminated roof  
 Aluminum running boards

Fiberglass exterior walls with vinyl graphics  
 Entrance door with industry's largest travel-view window  
 Electric-powered entrance step with integrated house battery compartment  
 Third brake light  
 4 in. bumper tube sewer hose storage  
 Cable TV hookup with RG-6 coax  
 Digital antenna with signal booster  
 4,000W generator  
 Solar prep  
 12V house battery  
 Transfer switch with reverse polarity protection  
 30-amp electrical service  
 12.2 gal. propane tank (41 lb.)  
 LP quick-connect hookup  
 Exterior utility center  
 Winterization drain system  
 Outside shower  
 12V demand water pump  
 Water filtration system

## STANDARD COCKPIT EQUIPMENT

Remote-controlled, side-view mirrors  
 Hill start assist  
 Tilt steering wheel  
 Cruise control  
 Electronic stability control  
 Traction control  
 Power windows and door locks  
 Auxiliary start switch  
 Driver and passenger airbags

## STANDARD INTERIOR EQUIPMENT

Overhead bunk with 750 lb. capacity  
 84 in. ceiling height  
 High-intensity, recessed LED ceiling lights  
 Hardwood cabinet doors  
 Ball-bearing drawer guides  
 Entegra-exclusive, easy-operation legless dinette table (22C, 22CF)  
 2-point lap safety belts in all designated seating locations  
 42 in. x 78 in. U-shaped dinette (22A, 22AF, 22E, 22EF)  
 48 in. dinette bench with removable table (22T, 22TF)  
 Interior entrance door grab handle  
 Interior command center

Pleated blackout shades  
 13,500 BTU ducted A/C  
 30,000 BTU auto-ignition furnace  
 6 gal. gas/electric DSI auto-ignition water heater  
 Smoke alarm  
 Carbon monoxide detector  
 Fire extinguisher  
 10 cu. ft. 12V refrigerator  
 2-burner cooktop with flush cover  
 Convection microwave oven  
 Stainless steel kitchen sink  
 Decorative kitchen backsplash  
 Queen-size bed with bedspread (22A, 22AF, 22C, 22CF, 22E, 22EF)  
 (2) twin-size beds with filler cushion convert to king-size bed (22T, 22TF)  
 Large wardrobes (select models)  
 Shower with decorative ABS surround and skylight  
 Stainless steel bathroom sink  
 Toilet with foot flush

## OPTIONS

Automatic hydraulic leveling jacks  
 200W solar panel with dual controller and second house battery



## NO ONE OFFERS A BETTER WARRANTY

At Entegra Coach, we build our RVs to handle every adventure, then back them with our industry-leading 2+3 limited warranty. Our 2-year limited warranty has you covered for 2 camping seasons. That's 730 days. In addition, our 3-year structural limited warranty has you covered for 3 camping seasons or 1,095 days. You won't find a better limited warranty in the business, because the only strings we attach are those that deliver the ultimate in reliability. For a copy of our 2-year limited + 3-year structural limited warranty with complete terms and conditions, please contact your local Entegra Coach dealer.

Floorplan	GVWR (lbs.)	GCWR (lbs.)	Wheel Base	Overall Length	Exterior Height w/ A/C & Satellite	Exterior Width	Interior Height	Fresh Water Capacity (gal.)	Grey Waste Water Capacity (gal.)	Black Waste Water Capacity (gal.)
22A	14,200	20,000	159"	25' 4"	11' 6"	100"	84"	44	40	32
22C	14,200	20,000	159"	25' 4"	11' 6"	100"	84"	44	40	31
22E	14,200	20,000	159"	25' 4"	11' 6"	100"	84"	44	40	31
22T	14,200	20,000	159"	25' 4"	11' 6"	100"	84"	44	40	31
22AF	12,500	18,500	158"	24' 9"	11' 6"	100"	84"	44	40	32
22CF	12,500	18,500	158"	24' 9"	11' 6"	100"	84"	44	40	31
22EF	12,500	18,500	158"	24' 9"	11' 6"	100"	84"	44	41	31
22TF	12,500	18,500	158"	24' 9"	11' 6"	100"	84"	44	41	31

It is important for your safety and enjoyment that you are aware of the weights and tow ratings of the RV you select. Consult a competent advisor for questions or advice. Whether you are new to RVing or a veteran, get a feel for the performance of your RV before heading out on the roadways. When you tow a vehicle with your RV, you must drive differently than when you drive a single vehicle. Practice hooking up, driving, backing up and braking in a safe environment or seek out professional instruction. Jayco affixes a weight label to each RV which lists weight information for that vehicle. Refer to that label to verify the vehicle will meet your requirements. Gross Vehicle Weight Rating (GVWR): The maximum permissible weight of the motorhome, including the Unloaded Vehicle Weight (UVW) plus passengers, personal items, all cargo, fluids, options and dealer-installed accessories. The GVWR is equal to or greater than the sum of the UVW and the Cargo Carrying Capacity. Gross Combined Weight Rating (GCWR): The maximum allowable combined weight of the motorhome used as a tow vehicle and the attached towed vehicle.

**LAMESA REC VAN**

LAMESA RV.com  
 800-496-8778

**ENTEGR A COACH**

Part of Jayco Family of Companies

Entegra Coach, Inc., P.O. Box 460, Middlebury, IN 46540, www.entegracoach.com. See dealer for further information and prices. All information in this brochure is the latest available at the time of publication approval. Entegra Coach reserves the right to make changes and to discontinue models without notice or obligation. Photos in this brochure may show optional equipment and props for photography purposes. RVs built for sale in Canada may differ to conform to Canadian codes. ©2025 Entegra Coach, Inc. Printed in U.S.A. 2032936



entegracoach.com/odyssey-se

LEGACY ISN'T LEFT,  
 IT'S LIVED.